



# WHAT IS A MODULAR HEARTH?

Each kit includes all parts needed to assemble a corner or standard modular hearth pad in our most popular sizes 36", 48" and 60".



MODULAR HEARTH

**HEARTH CLASSICS**

BY American Panel

PROTECTION SYSTEM

# THE MODULAR HEARTH PROTECTION SYSTEM™

## WHAT IS A MODULAR HEARTH?

- It is the most innovative approach to hearth protection.
- It is designed to solve issues of current production hearth pads - too many options, sizes, shapes, tile selections, freight damage, cracking/discoloring grout, and more.
- It is a patent-pending hearth pad containing only non-combustible material.
- It is designed around our patented "Modular Panel" in which we tight set the tile to a patent-pending engineered steel backer panel. Panels are designed to be put together with locking strips for a Type 1 (T1) hearth pad or simply laid into a frame for a Type 2 (T2) hearth pad.
- It is packaged so that the most popular sizes will allow assembly of either a standard shape or corner shape Type 2 (T2) hearth pad.

### It is a hearth pad that:

- ships in a well engineered box designed to protect the hearth pad from damage.
- is easy to handle – all sizes (except 60" x 60") ship in a 48"L or 36"L x 12"W x 7"H box.
- 60" hearth pads ship in two boxes – one 48"L x 12"W x 7"H and one 36"L x 12"W x 7"H.
- is designed so replacement parts can be sent out immediately in the event damage does occur.
- will continue to provide maximum protection in the event a tile cracks.
- produces minimal waste and uses no water - Green Manufacturing.
- eliminates grout with tight set tile.
- is built only as a Type 2 (T2) modular hearth pad when using the frame.
- eliminates any worry over whether a Type 1 (T1) or a Type 2 (T2) is needed, thus further reducing the number of SKU numbers.
- is available as an inexpensive Type 1 (T1) modular hearth pad if used without a frame – available in square or rectangle shapes only.

## TYPE 1 (T1) - HEARTH PAD (NO FRAME) (EMBER PROTECTION ONLY)

All wood, pellet, coal, corn and many gas stoves require a hearth pad or hearth protection. Most require only protection from falling embers. If this is the case with your stove, you can use a Type 1 (T1) without a frame.

### No Frame

- Available as square or rectangle shapes only.
- Modular panel(s).
- Locking strips and aluminum tape must be used to provide a continuous solid, non-combustible, steel substrate.



No Frame

Shapes (inches)	A	B
<b>SQUARE</b>		
36 x 36	36	36
48 x 48	48	48
<b>RECTANGLE</b>		
12 x 48	12	48
18 x 48	18	48
36 x 48	36	48
48 x 60	48	60
60 x 48	60	48

## TYPE 2 (T2) - HEARTH PAD (WITH FRAME) (EMBER SHIELD AND THERMAL PROTECTION)

### R-Value 1.61

The Type 2 (T2) modular hearth pad with frame is provided only as a Type 2 (T2) to take the guess work out of needing a Type 1 (T1) or Type 2 (T2).

### 1¼" Original Edge

- Powder coated frame.
- Heavy duty tube aluminum frame.
- Provide maximum support under stove.
- Does not rely on air pocket for thermal value.
- Provides best possible thermal protection available in 1¼" frame.
- ½" non-combustible mineral fiber board (thermal protection).
- ¼" non-combustible cement substrate
- Modular panels.



Original Edge

## AVAILABLE TILE OPTIONS



Canyon



Charcoal



Desert



Black Hills

# INSTALLING YOUR MODULAR HEARTH PROTECTION SYSTEM

## TYPE 1 (T1) – EMBER PROTECTION

*Built for installation without a frame.* Create the size you want from as small as 12"x24" to as large as 48"x60".

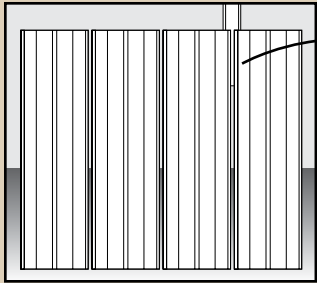

1. With tile facing the wall, stand panels vertically on cardboard to protect the tile. Leave about 1/4" between panels.

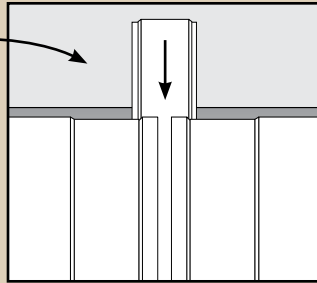

2. Wearing gloves, insert a locking strip under the metal edges of 2 panels where they meet. Slide strips down to the floor. Repeat at each joint.

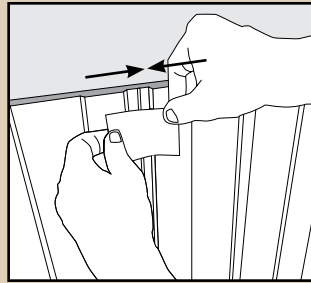

3. Push panels tightly together and check for squareness.

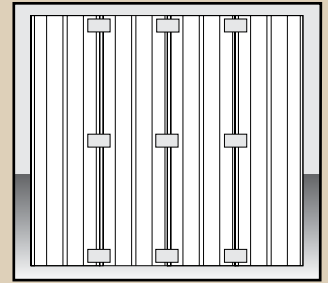

4. Evenly space 3 pieces of aluminum tape along the joint. Repeat at each joint to form a single unit.

## TYPE 2 (T2) – THERMAL PROTECTION

*Built for installation with a frame.* 36" corner modular hearth pad assembly instructions below. Colors altered to show difference between the Micore 300 and Cement Board substrates. For instructions on all available sizes, please visit [www.hearthclassics.com](http://www.hearthclassics.com).



1. Unpack the frame pieces, substrate panels, and modular panels.

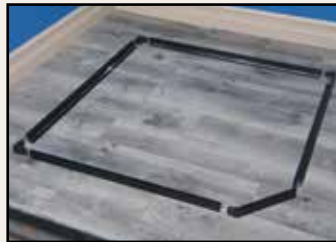

2. Lay out all frame pieces to form the 36" corner modular hearth pad shape.



3. Place the frame together using the provided corner pieces and plugs.

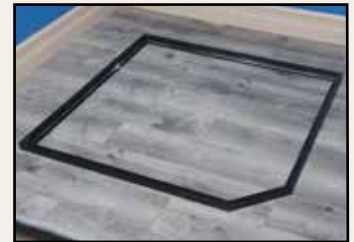

4. Plugs are designed to be snug but can be pushed together without tools.



5. Lay in (1) 12" x 36" Micore 300 rectangle piece with two end cuts.



6. Lay in the Micore 300 triangle piece.



7. Lay in (1) 12" x 36" Micore 300 rectangle piece.



8. Lay in the remaining 12" x 36" Micore 300 rectangle piece.



9. Lay in (1) 6" x 36" Cement Board rectangle piece with two end cuts.



10. Lay in the Cement Board triangle piece and (1) 12" x 36" Cement Board rectangle piece.



11. Lay in the remaining 12" x 36" Cement Board rectangle piece.



12. Finish with (1) 6" x 36" Cement Board rectangle piece.



13. Lay in the 12" x 24" Modular Panel with one end cut.



14. Lay in the 12" x 12" square Modular Panel.



15. Lay in (1) 12" x 36" Modular Panel.

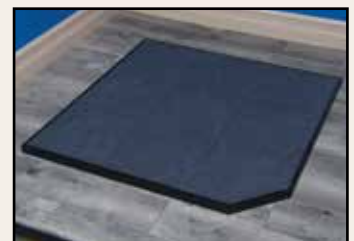

16. Lay in remaining 12" x 36" Modular Panel. Make sure the tile lines are straight and all modular panels are pushed to center.



# DIMENSIONS

Shapes (inches)	A	B	C	D	E	F
<b>EXTENSION</b>						
12 x 48	12	48	7 ¾	39 ½	6	NA
18 x 48	18	48	13 ¾	39 ¾	6	NA
<b>CORNER (CR)</b>						
36 x 36	36	36	30 ½	30 ½	7	43
48 x 48	48	48	37 ½	37 ½	15	60
60 x 60	60	60	49 ½	49 ½	15	77
<b>STANDARD (ST)</b>						
36 x 36	36	36	30 ½	30 ½	12	NA
48 x 48	48	48	37 ½	37 ½	15	NA
60 x 60	60	60	49 ½	49 ½	15	NA
48D x 60W ST	48	60	37 ½	39 ½	15	NA
60D x 48W ST	60	48	48 ½	27 ½	15	NA

Due to groutless tile setting and variations in tile dimensions, pad sizes are slightly smaller than listed.

Additional panels can be added to extend the Modular Hearth beyond the maximum sizes. Special sizes and very large sizes available in 12" increments.

## 1 SIZE HEARTH PAD – 2 SHAPES

Each kit includes all parts needed to assemble a corner or standard modular hearth pad in our most popular sizes 36", 48" and 60".

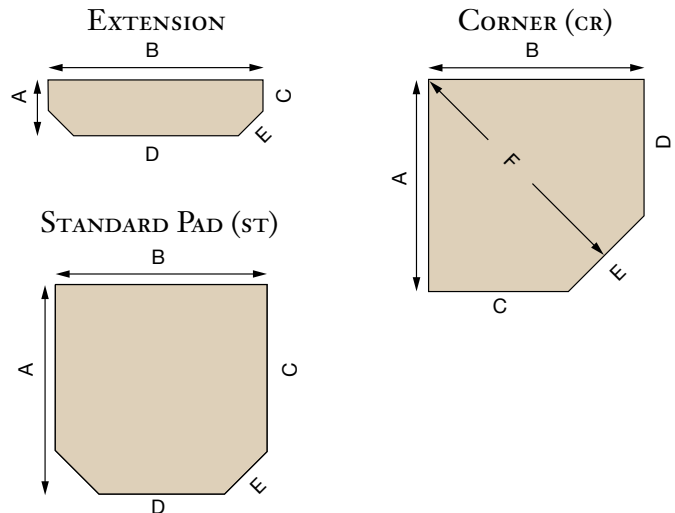

## ALSO AVAILABLE...

### DID YOU KNOW? MODULAR HEARTH'S CAN BE USED FOR DECK PROTECTION

- Modular panels with spacers allows airflow beneath the deck protector, reducing moisture build-up on your deck.
- Will withstand damp and cold weather.
- Makes a great ember protector under fire pits\* or grills.

\* Not suitable for units requiring Thermal Protection.

