



MODULAR HEARTH

**HEARTH CLASSICS**  
BY American Panel

DECK PROTECTION



AVAILABLE TILE AND SLATE OPTIONS



*Polished Copper*



*Volcanic Sand*



*Desert*



*White Sand*



*Black Hills*

**TYPE I – EMBER PROTECTION**

**Without Frame**

- Modular Panels and Locking Strips

**With Frame**

- Modular Panels and 1/2" Non-combustable Substrate

# INSTALLING YOUR MODULAR HEARTH PROTECTION SYSTEM

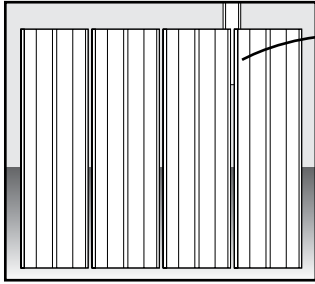

1. With tile facing the wall, stand panels vertically on cardboard to protect the tile. Leave about 1/4 between panels.

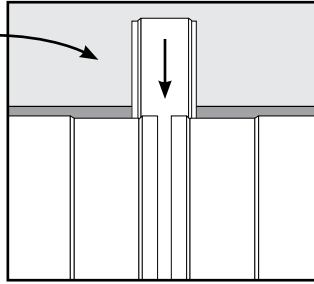

2. Wearing gloves, insert a locking strip under the metal edges of 2 panels where they meet. Slide strips down to the floor. Repeat at each joint.

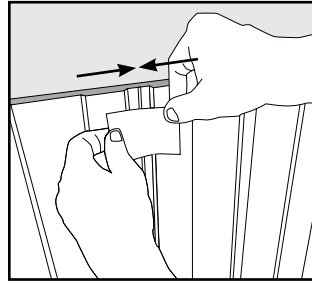

3. Push panels tightly together and check for squareness.

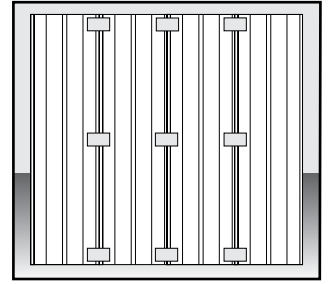

4. Evenly space 3 pieces of aluminum tape along the joint. Repeat at each joint to form a single unit.

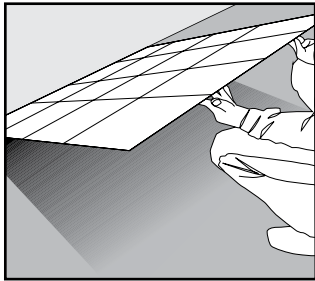

5. Lay unit down on solid, flat floor. **Do not install directly over carpet.** If there is carpet, cut 1/2" particle board, plywood or OSB to same size as pad and lay between pad and carpet.

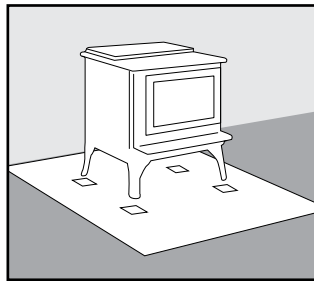

6. You can add wood, metal or plastic trim to protect tile edges and hide the board if on carpet.  
7. For stoves with legs, place a Load Spreading Disk (4 included) beneath each leg to prevent pressure cracks.

## FOR USE ON PRESSURE TREATED DECKING

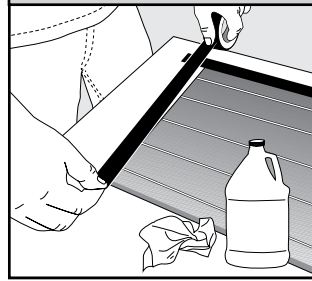

**Paint the metal panels first.** Lay each panel on shipping box, metal side up. Apply masking tape all around edges to prevent overspray onto the tile. Wipe metal with distilled vinegar to open the pores of the metal.

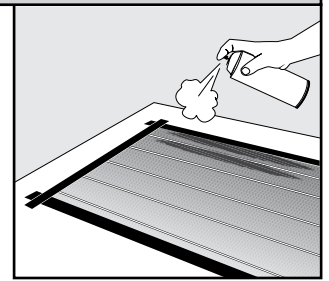

Paint the metal panels using any outdoor paint designed for galvanized metal. Color is not important. Apply 2 coats for best protection from corrosion.

## WARNING

- Install on flat, level floor. See step 5 above.
- \*The MHPS provides Ember Protection only. Not suitable for stoves, inserts, fire pits, chimineas or other heating appliances requiring Thermal Protection (see appliance manual for thermal requirements). It will not prevent heat from transferring to surface below.
- If used on pressure-treated deck material, painting the underside will prevent corrosion caused by the chemical reaction between galvanized steel and the chemicals in the wood.
- Not for use in sub-freezing temperatures.
- Tile dimensions may vary slightly. If there is a slight variation in panel length, align the edges that are most visible.

## SIZES

Due to groutless tile setting and variations in tile dimensions, pad sizes are slightly smaller than listed.

Number of panels is in parentheses.

Additional panels can be added to extend the Modular Hearth beyond the maximum sizes shown here.

## OPTIONS USING 24" AND 36" PANELS

MH-REC2424MH-REC2436 MH-REC3636  
(2) 12" x 24" (2) 12" x 36" (3) 12" x 36"

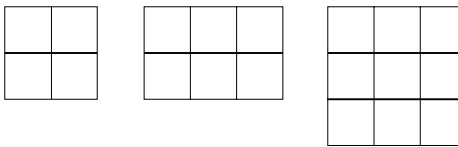

## OPTIONS USING 48" PANELS

MH-REC2448 MH-REC3648 MH-REC4848  
(2) 12" x 48" (3) 12" x 48" (4) 12" x 48"

